

## 6218-2Z Deep groove ball

### bearings

- Popular item

- SKF Explorer

### Deep groove ball bearings

#### Bearing data

[Tolerances](#),

Normal (metric), P6, P5, Normal (inch),

[Radial internal clearance](#),

Matched bearing pairs, Stainless steel  
d < 10 mm, Other bearings

#### Bearing interfaces

[Seat tolerances for standard conditions](#),

[Tolerances and resultant fits](#)

## Technical specification

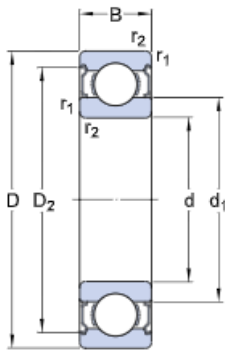

### DIMENSIONS

d	90 mm	Bore diameter
D	160 mm	Outside diameter
B	30 mm	Width
d <sub>1</sub>	≈ 112.5 mm	Shoulder diameter
D <sub>2</sub>	≈ 142.6 mm	Recess diameter
r <sub>1,2</sub>	min. 2 mm	Chamfer dimension

### ABUTMENT DIMENSIONS

d <sub>ε</sub> min.	101 mm	Diameter of shaft abutment
d <sub>ε</sub> max.	112 mm	Diameter of shaft abutment
D <sub>i</sub> max.	149 mm	Diameter of housing abutment
r <sub>a</sub> max.	2 mm	Radius of shaft or housing fillet

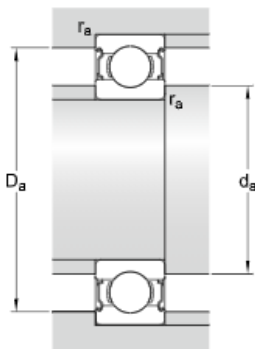

## CALCULATION DATA

C	101 kN	Basic dynamic load rating
C <sub>0</sub>	73.5 kN	Basic static load rating
P <sub>u</sub>	2.8 kN	Fatigue load limit
	8 500 r/min	Reference speed
	4 300 r/min	Limiting speed
k <sub>r</sub>	0.025	Minimum load factor
f <sub>0</sub>	14.7	Calculation factor

## MASS

	2.3 kg	Mass bearing
--	--------	--------------

## TOLERANCE CLASS

P6	Dimensional tolerances
Normal	Radial run-out